

Visitor Guide
and Map



Art in Bloom

A CELEBRATION OF ART AND FLOWERS

March 1–3, 2024



Vote online for
your favorite
arrangements

SAINT LOUIS ART MUSEUM



Welcome to Art in Bloom, the Saint Louis Art Museum's annual celebration of flowers and fine art. This year, 30 works from the Museum's collection have been imaginatively interpreted by some of the region's most talented floral designers. In addition to these displays, the festival includes special ticketed events, family activities, dining, and shopping.

We express our deepest gratitude to our Art in Bloom Preview Party chairs, Friends Board members Ken Stuckenschneider and Cheree Berry, for their leadership, creativity, and enthusiastic support.

Featured Events

Floral Frenzy

Friday, March 1, 6–7:30 pm
The Farrell Auditorium
Free; ticket required

Enjoy a fun and fragrant competition between teams of floral designers to beat the clock and each other in a series of fresh and surprising creative challenges. Generous support provided by Art Bridges Foundation's Access for All program.

Art Bridges
Foundation

ACCESS
FOR ALL



Featured Speaker: Doan Ly

Saturday, March 2, 2–3 pm
The Farrell Auditorium
\$25/\$15 Members; ticket required

Doan Ly, founder and artistic director of a.p. bio floral design and photography studio in New York City, will discuss her multidisciplinary practice and demonstrate her creative process in floral design. Ly will sign copies of her book *Still Life* (2023) immediately following the program. Copies of the book will be available for purchase in the Museum Shop.



Doan Ly

Flowers After Hours

Saturday, March 2, 6–9 pm
\$45/\$35 Members; tickets required

Avoid the daytime crowds by attending Flowers After Hours, a limited-capacity experience on Saturday evening with live music, cocktails, and more for visitors 21 and older. Your ticket includes one signature cocktail, glass of champagne, domestic beer, or sparkling water. Additional beverages and light snacks will be available for purchase.



Family Florals

Sunday, March 3, noon–4 pm
Free; ticket not required

Bring the whole family for floral-inspired art activities and a scavenger hunt through the galleries.

Family Florals
Sponsor:

CALERES
EST • 1878

Art in Bloom Programs at a Glance

FRIDAY, MARCH 1

Festival Hours 10 am–9 pm

Early Morning Entry for Members
8–10 am

Lunch Buffet
10 am–2 pm, Panorama
\$25 / \$21 Members
Reservations strongly recommended.

Flower Happy Hour
11 am–8:30 pm,
Sculpture Hall
Drinks and light snacks
available for purchase.
Live music from 5–8 pm.
Free.

Dinner Buffet
5 pm–8 pm, Panorama
\$48 / \$42 Members
Reservations strongly
recommended.

Floral Frenzy
6–7:30 pm,
The Farrell Auditorium
Free; ticket required.

SATURDAY, MARCH 2

Regular hours 10 am–5 pm, with expanded access from 6 pm to 9 pm with Flowers After Hours admission

Early Morning Entry for Members
8–10 am

Lunch Buffet
10 am–2 pm,
Panorama
\$25/\$21 Members
Reservations strongly
recommended.

Flower Happy Hour
11 am–4:30 pm,
Sculpture Hall
Drinks and light snacks
available for purchase.
Free.

Featured Speaker: Doan Ly
2–3 pm, The Farrell
Auditorium
\$25/\$15 Members;
ticket required.

Flowers After Hours
6–9 pm
\$45/\$35 Members;
ticket required

Dinner Buffet
6–8 pm, Panorama
\$48/\$42 Members
(Flowers After Hours
admission required)
Reservations strongly
recommended.

SUNDAY, MARCH 3

Regular hours 10 am–5 pm

Early Morning Entry for Members
8–10 am

Lunch Buffet
10 am–3 pm, Panorama
\$25/\$21 Members
Reservations strongly
recommended.

Family Florals
noon–4 pm, Sculpture Hall
Free; ticket not required.



Art in Bloom Family Day

Sunday, March 3, noon–4 pm

Family Florals
Sculpture Hall

Families are invited to make their own floral-and nature-inspired artwork to take home. Families can also set off on a self-guided scavenger hunt to explore the artful wonders in the galleries.

Family Florals is sponsored by Caleres.

Art in Bloom Dining

Enjoy unique dining opportunities throughout the festival.
Museum Members save 10 percent.



PANORAMA

Art in Bloom Dining at Panorama

Enjoy a delicious buffet of soups, sandwiches, salads, and desserts at Panorama. Reservations are highly recommended, and sellouts may occur. Reservations can be made online at slam.org/dining or resy.com or by calling Panorama at 314.655.5490.

Lunch Buffet
Friday and Saturday, 10 am–2 pm
Sunday, 10 am–3 pm
\$25 / \$21 Members

Dinner Buffet
Friday, 5 pm–8 pm
Saturday, 6 pm–8 pm
(Flowers After Hours admission required)
\$48 / \$42 Members

Cafe & Garden View Lounge

For more casual fare, the Cafe serves soups, salads, sandwiches, and snacks. Relax, recharge, and enjoy views of the Blanke Sculpture Terrace. Grab lunch, snacks, or beverages from the Cafe to enjoy in this comfortable setting or simply take a break.

Cafe specials for Art in Bloom include:

- Mini Ceviche Cones
- Warm Savory Pastry Blossoms (vegan optional)
- Chocolate Drizzled Fruit Skewers (gluten free, vegetarian)
- Meringue Mini Pies (vegan)
- Serendipity Ice Cream Bonbons (gluten free, vegan)

Friday, 8 am–8 pm
Saturday, 8 am–4 pm and 6 pm–8 pm
(Flowers After Hours admission during evening hours)
Sunday, 8 am–4 pm

WKFL
Walter Knoll Florist
We Know Flowers

Cafe & Garden View Lounge florals
generously provided by Walter Knoll Florist.

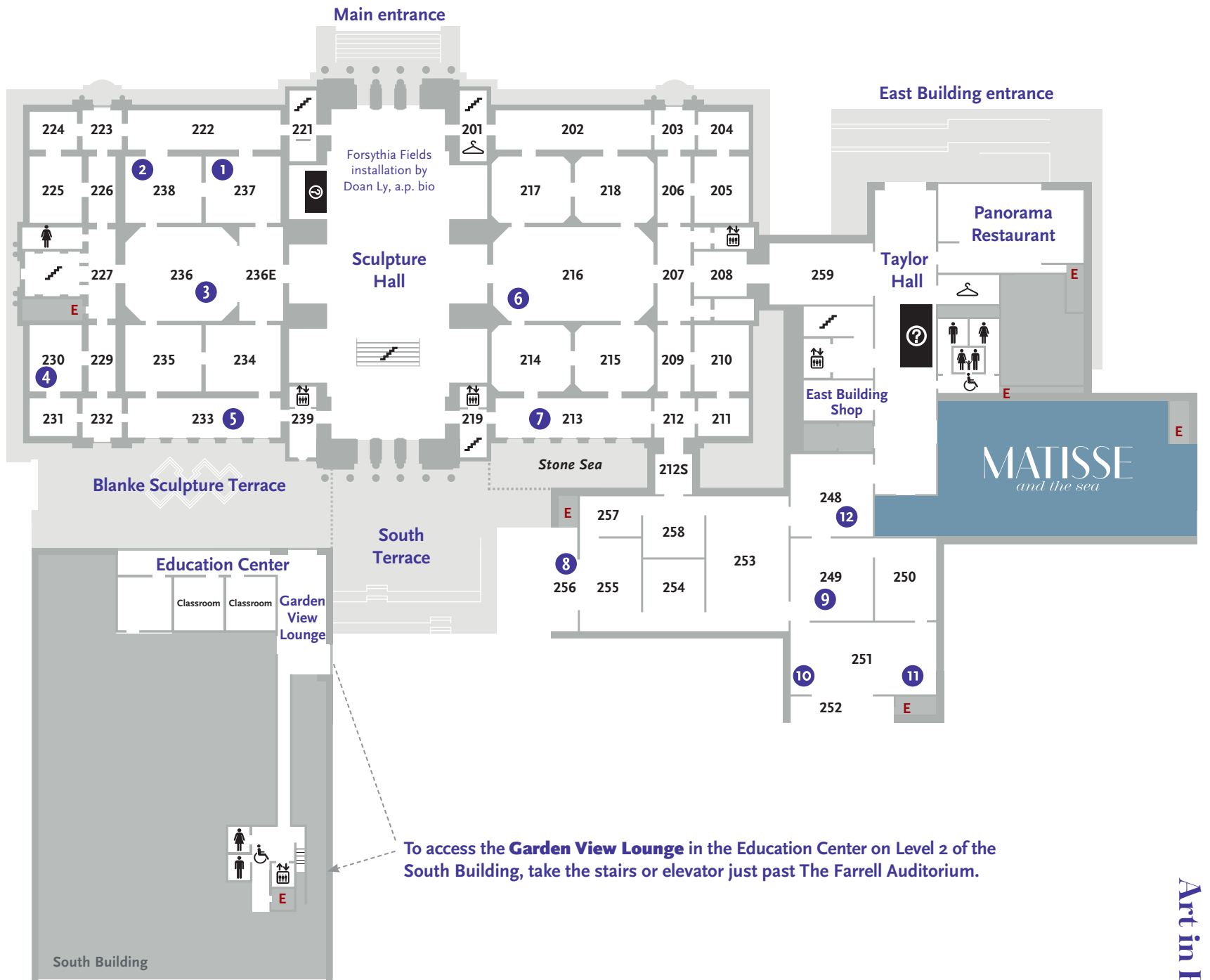

To access the **Garden View Lounge** in the Education Center on Level 2 of the South Building, take the stairs or elevator just past The Farrell Auditorium.

1 Gallery 237
 Boss, French
 Therese Pircon
 Root & Relic

2 Gallery 238
 Workshop of Rembrandt van Rijn
 Karen Suedkamp
 Alex Waldbart Florist

3 Gallery 236
 Portrait of a Florentine Nobleman, Francesco Salviati
 Elisabeth Roeleveld
 Les Bouquets

4 Gallery 230
 Dish with Design of EightPetaled Flower, Chinese
 Ratissia (Tee) Johnson
 Dirty Blossom

5 Gallery 233
 Ornament in the Form of a Coiled Snake, Chinese
 Sophia Larsen
 39th Street Floral

6 Gallery 216
 Carnival Mask, Green, Violet, and Pink (Columbine),
 Max Beckmann
 Teresa Layton and Ashley Putnam
 Sisters Floral Design Studio

7 Gallery 213
 Eiffel Tower, Robert Delaunay
 Erin Higgins-Wilson
 Belli Fiori Wedding and Event Design

8 Gallery 256
 Untitled, Ellsworth Kelly
 Erika Jackson
 River Valley Flower Farm

9 Gallery 249
 Untitled (Quiet Strength VI),
 Dyani White Hawk
 Dean Riebeling
 Botanicals Design Studio

10 Gallery 251
 Betty, Gerhard Richter
 The Garden Club of St. Louis

11 Gallery 251
 Ölberg, Gerhard Richter
 Rich West
 RW Designs

12 Gallery 248
 Irawo II, Wole Lagunju
 Ken Mahne
 Petal Pushers STL

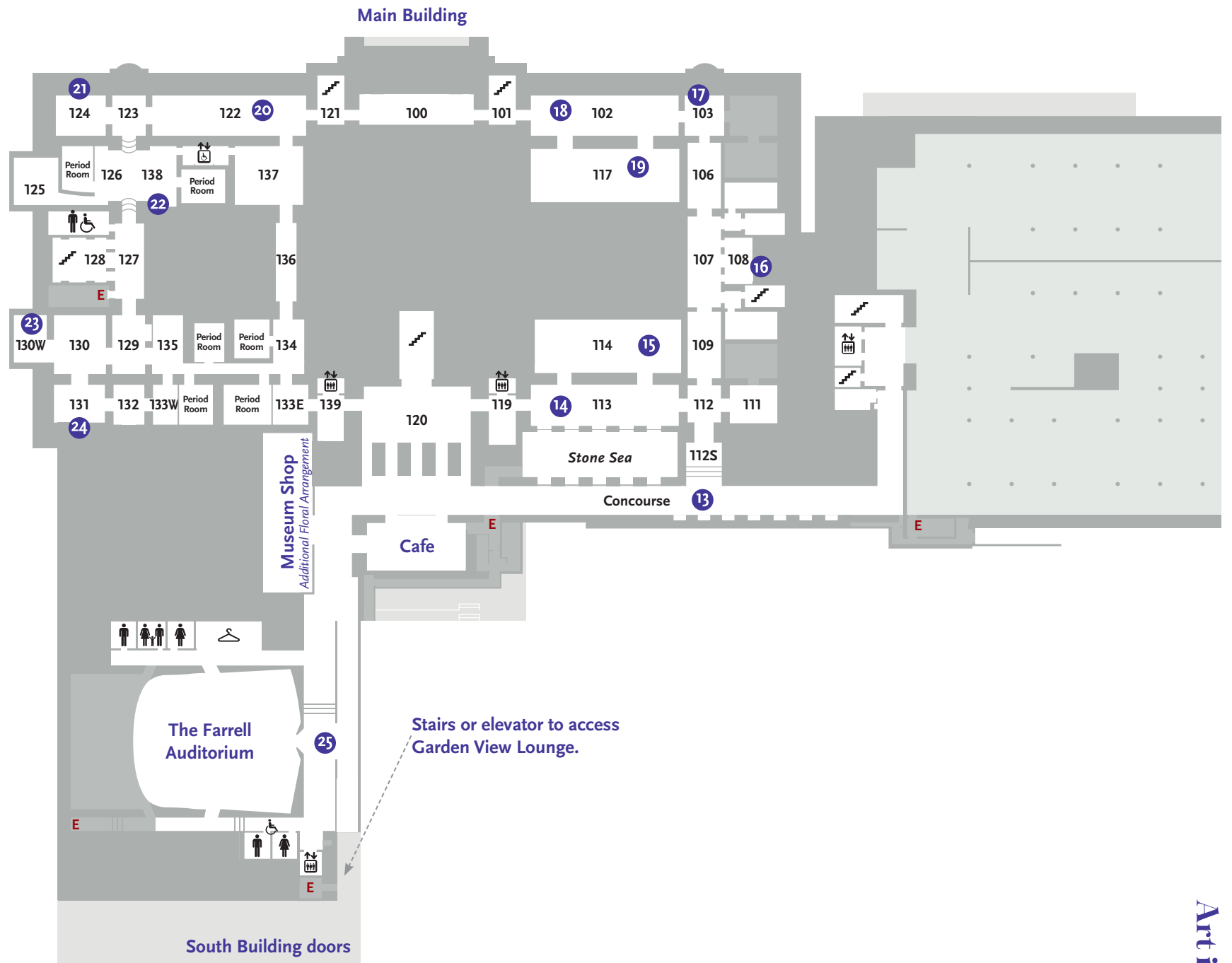

13 Concourse

Clerestory Window, from the Madison State Bank, Madison, Minnesota, George Grant Elmslie, William Gray Purcell, and Mosaic Art Shops (E.L. Sharretts)
Darien Burreuss
Black Girl in Bloom

14 Gallery 113

Vessel with Painted Motifs in the Form of a Gourd, San Pablo
Joseph Thomasson, AIFD, CFD
Stems Florist

15 Gallery 114

Deer Pendant, Maya
Diana Zimmermann
Walter Knoll Florist

16 Gallery 108

Breastplate (civavonovono), Fijian artist Kira Mulvany, Cynthia Ryan, Carly Bohmer, Kelsey Caldwell, Lydia Wegener, Sheri Burke, and Lois Cassimatis
Roses & Mint Florals

17 Gallery 103

Mountain Devil Lizard Dreaming, Gloria Tamerr Petyarr
Ann Rabbitt, AIFD, CFD
Thorn Studio

18 Gallery 102

Crest Mask (ci-wara kun), Bamana artist
Lucy Willis
Lucy Willis Interiors

19 Gallery 117

Man's Robe (agbada or riga), Yoruba, Hausa, or Nupe artist
Heath Daniel
39th Street Floral

20 Gallery 122

Pair of Vases from the Swan Service, Johann Joachim Kändler and Meissen
Porcelain Factory
Ben Zielinski
Fields and Fern

21 Gallery 124

Chest, Italian
Zachary Bair
Grimm & Gorly Florist

22 Gallery 138

Priming Flask, Dutch or German
Sandra Fulton
Petals Galore Floral Art

23 Gallery 130W

Space VI, Jaroslava Brychtová and Stanislav Libenský
Joshua Davis
Botanicals Design Studio

24 Gallery 131

Wirering Wall Lamp, Formafantasma and Flos, S.p.A.
Carly Meyer
Jessica Douglass
Flowers and Weeds

25 Auditorium Lobby

Sailboats, Roy Lichtenstein
David Bovier
Ken Miesner's Flower Shoppe



26 Gallery 333
Levigator Abstraction, Esphyr Slobodkina
 David Doom
 Walter Knoll Florist

27 Gallery 335
The Country School, Winslow Homer
 Rebecca Bodicky
 Alice Blue Collective

28 Gallery 336
The Land of Evangeline, Joseph Rusling Meeker
 Sara Ward
 Wildflowers

29 Gallery 336
Zenobia in Chains, Harriet Goodhue Hosmer
 Morgan Hopkins
 Flowers to the People

30 Gallery 338
Daniel Interpreting to Belshazzar the Writing on the Wall, Benjamin West
 Frankie Peltier, AIFD, CFD and
 Josh Brower
 Festive Couture Floral



Harriet Goodhue Hosmer, American (active Italy), 1830–1908;
Zenobia in Chains, c.1859; marble; 44 1/4 x 14 x 18 inches;
 Saint Louis Art Museum, American Art Purchase Fund 19:2008

MATISSE

and the sea



On view through May 12

Experience the first exhibition to examine the significance of the sea across Henri Matisse's career! Marine imagery was an inspiration for Matisse's artistic experimentation—most notably in the Saint Louis Art Museum's own iconic painting *Bathers with a Turtle*. The exhibition offers the opportunity to explore the artist's travel across his career as well as the global influences that informed his art.

For more information and tickets, visit slam.org/Matisse.

The exhibition is organized by the Saint Louis Art Museum.

Funding for this exhibition is provided by the Edward L. Bakewell Jr. Endowment for Special Exhibitions. In-kind support is provided by Christie's.

This exhibition is supported by an indemnity from the Federal Council on the Arts and the Humanities. Produced with the support of the French American Museum Exchange (FRAME).



Henri Matisse, French, 1869–1954; *Seated Woman, Back Turned to the Open Window*, c.1922; oil on canvas; 28 7/8 x 36 7/16 inches; The Montreal Museum of Fine Arts, Purchase, John W. Tempest Fund 2024.07; © 2024 Succession H. Matisse / Artists Rights Society (ARS), New York

Join today!

Save \$10 on membership during Art in Bloom

- FREE tickets to all ticketed exhibitions
- \$5 parking in the garage
- Museum Magazine and enews
- 10 percent off all shopping and dining
- Object of the Day email subscription
- Invitations to Member Mornings and Lectures

Visit either welcome desk to join.

Please note: the discount is available in person only and cannot be applied to previous membership transactions. Additional discounts do not apply.

Offer valid through March 3, 2024.

